



특징 (Character)

- 스프링에 의한 Normal closing 방식
Normal closing gripper by spring
- 롤러 가이드의 병렬배치로 내구성 및 동작안정성 증가
Increase durability and movement stability through roller guide parallel layout
- 비틀림에 강한 플런저
Twisted it is strong hardness plunger
- 높은 반복 정밀도
High repeatability



메카니컬 방식 (Mechanical type)

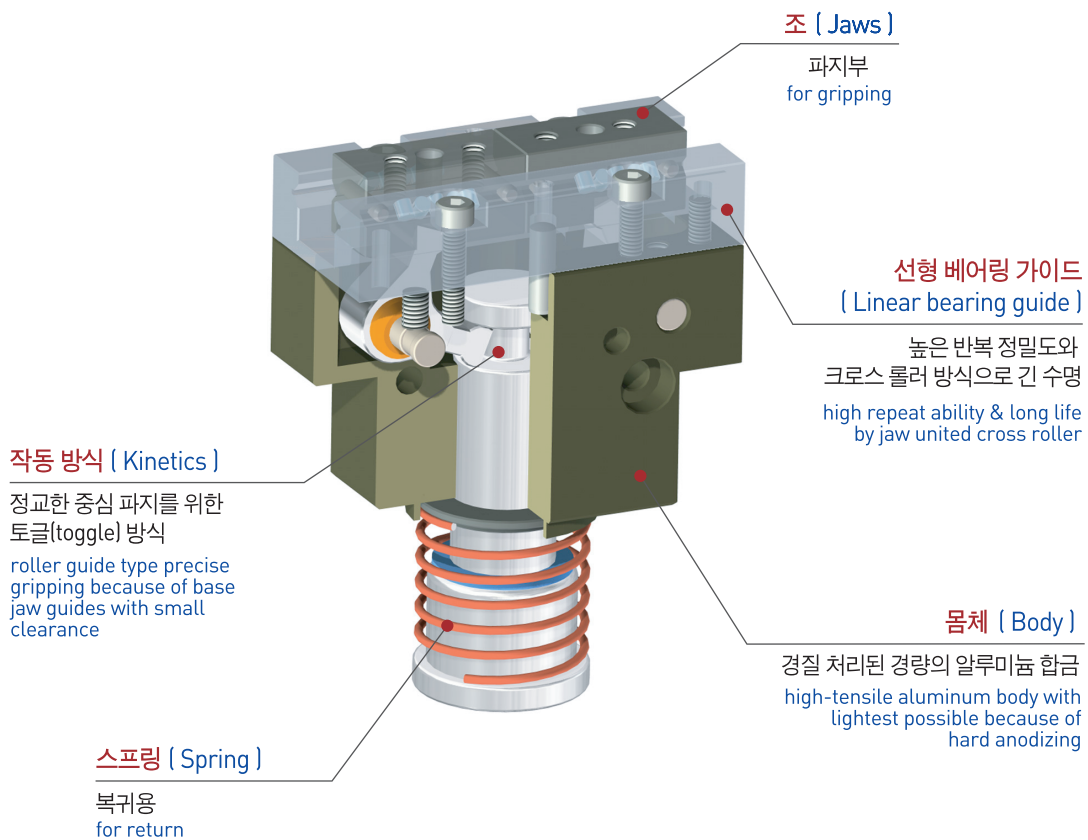

부품분해도 (Exploded view)

※ 본 분해도는 한 제품을 예시하였으므로 기종별로 차이가 있을 수 있습니다.
 ※ This is exploded view illustrates a certain product only. The contents may vary by product models.

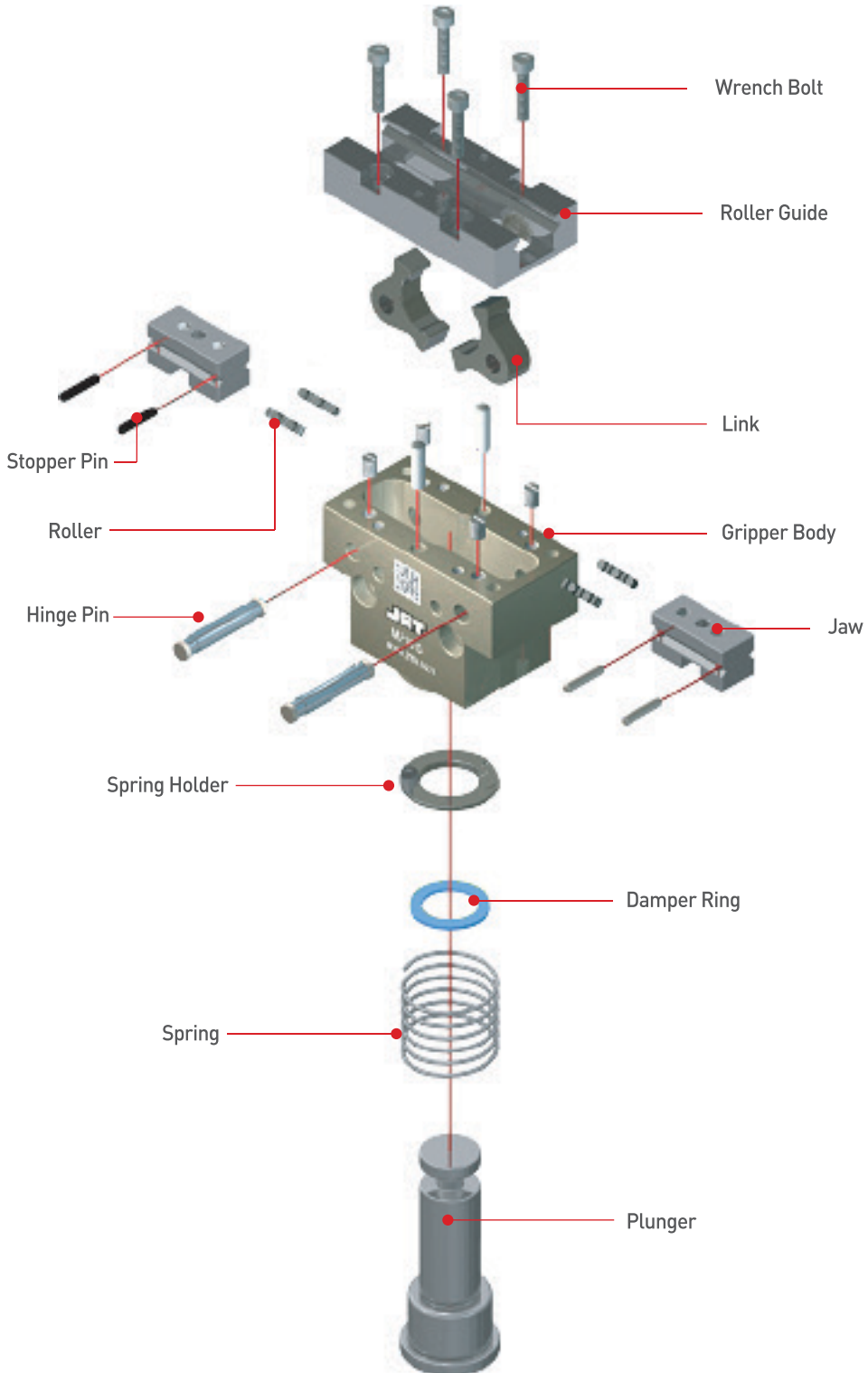

- AF101
- AF02
- AF03
- AF04P
- AF105P
- AF06
- AF10
- AF13
- AF13C
- AF14
- AF15
- AF316
- AF17
- AF117
- AF19
- AF24
- AF26
- AF28D
- AF30
- AF30L
- AF30SP
- AF40
- AF46
- AF56N
- RAF56N
- MF16

주문기호 (Ordering Code)

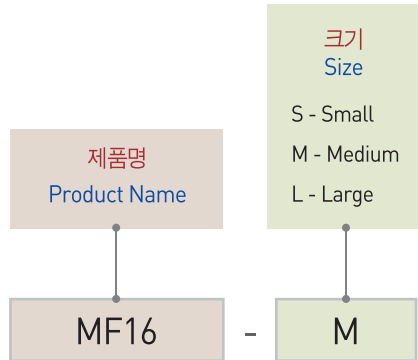

제품사양 (Specification)

P=공기압력(bar) , L=작용점까지의 거리(mm)
P=Air Pressure(bar) , L=Exertion length(mm)

| 제품명칭 Products Name | MF16-S | MF16-M | MF16-L | 단위 Unit |
|-------------------------------------|----------|-----------------|----------|------------|
| 개폐범위 Stroke | 12 | 14 | 16 | mm |
| 제품중량 Weight | 0.2 | 0.34 | 0.5 | kg |
| 최대치구길이 Max. length attach | 32 | 40 | 60 | mm |
| 파지력 : 닫힘시 Gripping force : Close | 10 to 20 | 15 to 30 | 25 to 40 | N |
| 연속사용회수 Continuation usage amount | 60 | 50 | 40 | cpm |
| 주위온도 Ambient temperature | | -5 to 60 | | °C |
| 윤활 Lubrication | | 불필요 Needless | | |

MF16-S

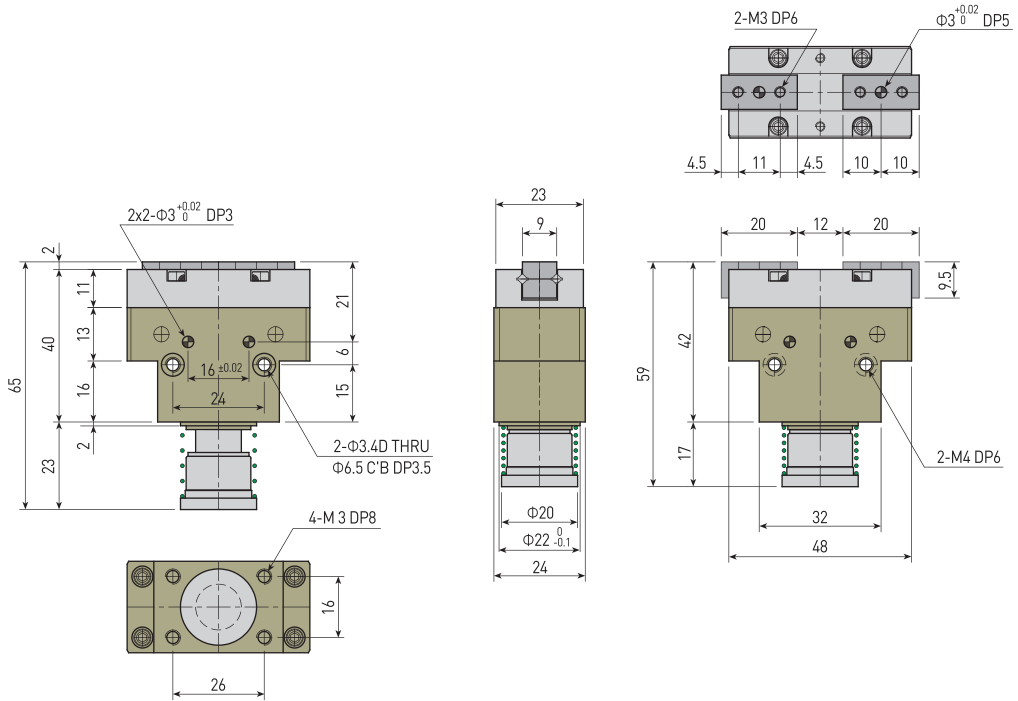

MF16-M

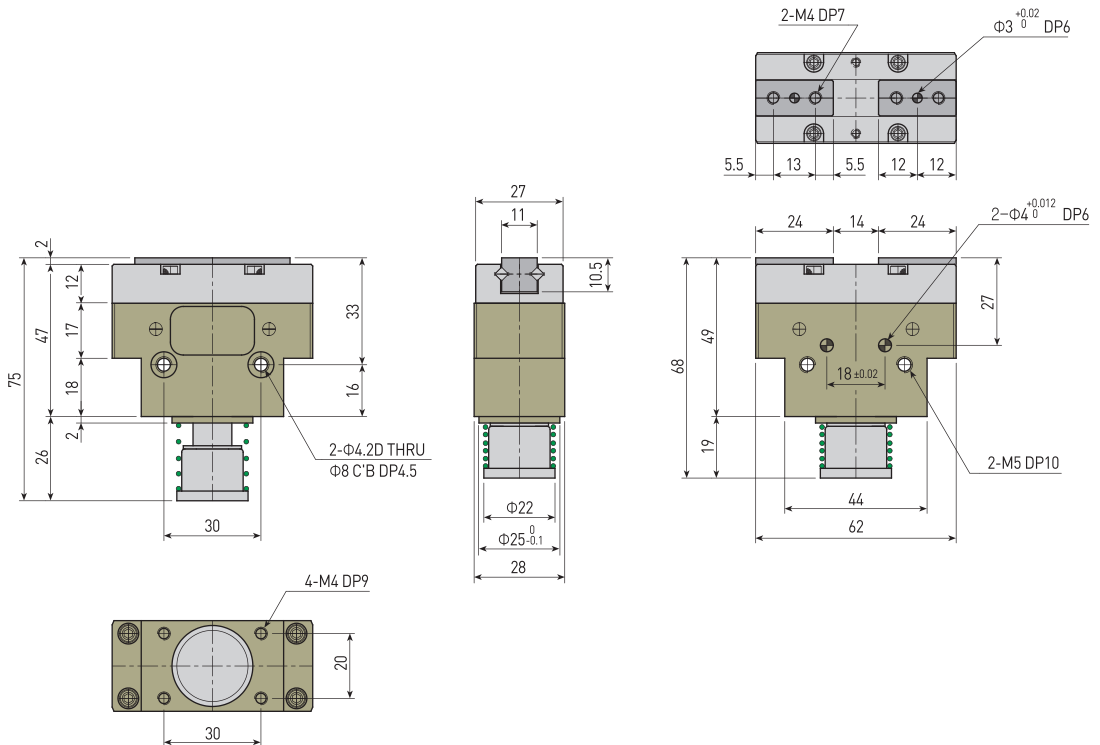

- AF101
- AF02
- AF03
- AF04P
- AF105P
- AF06
- AF10
- AF13
- AF13C
- AF14
- AF15
- AF316
- AF17
- AF117
- AF19
- AF24
- AF26
- AF28D
- AF30
- AF30L
- AF30SP
- AF40
- AF46
- AF56N
- RAF56N
- MF16

MF16-L

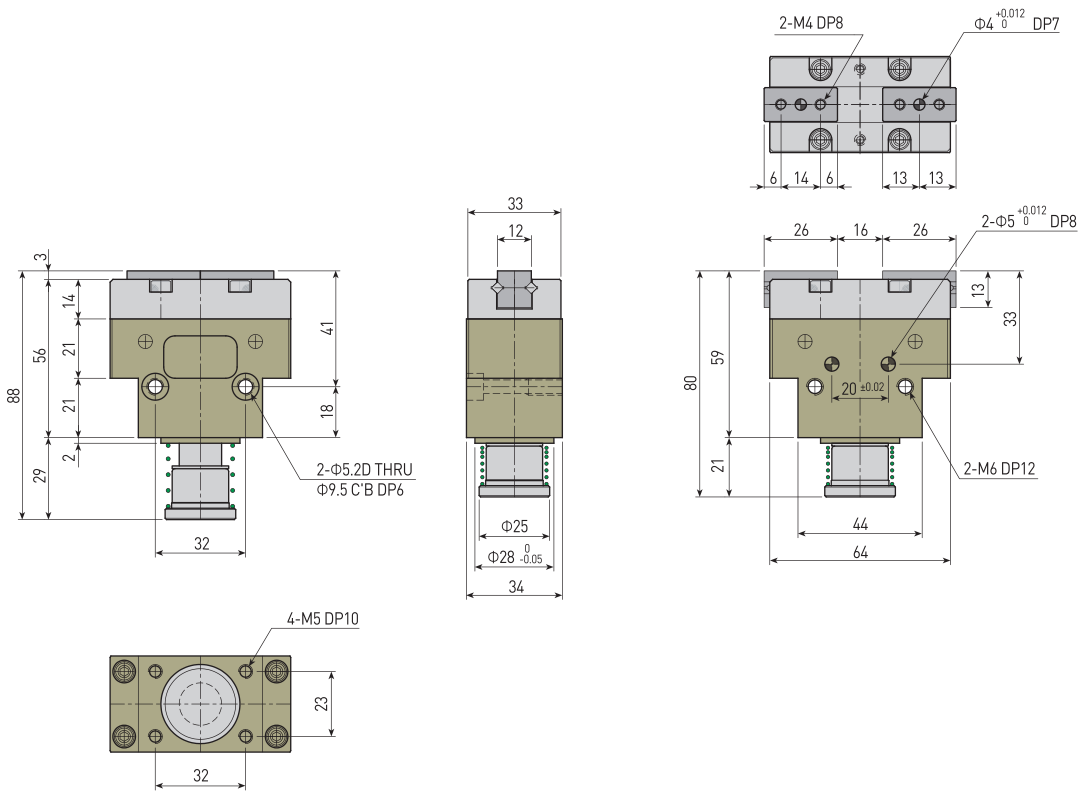

NOTE